

Specifications:

Contact rating:	12 V DC, 50 mA
Contact resistance:	< 100 mΩ
Insulation resistance:	> 100 MΩ at 500 V DC
Dielectric strength:	250 V, 50 Hz for the duration of 1 minute
Operating temperature:	-40 °C to +85 °C
Electrical life:	1.0 N/1.6 N: minimum 200 000 cycles 2.6 N: minimum 100 000 cycles 3.2 N/5.2 N: minimum 50 000 cycles
Operating force:	see ordering code
Contacts:	phosphor bronze, silver-plated
Terminals:	brass, silver-plated
Material:	cover: stainless steel base and stem: nylon meets UL 94 V-0; caps ABS
Mounting:	on pc-board – SMD
Soldering conditions:	hand-soldering – max.: 30 W, 2 sec, 320 °C
Travel:	0.25 mm + 0.2/- 0.1 mm

Models:

TSS 6

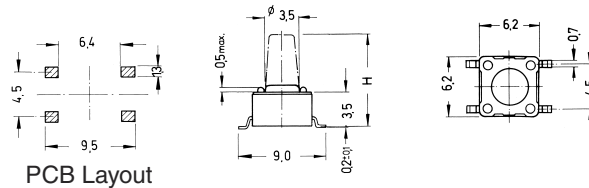

TSS 644

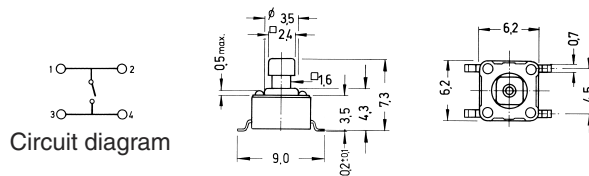

Caps for TSS 644

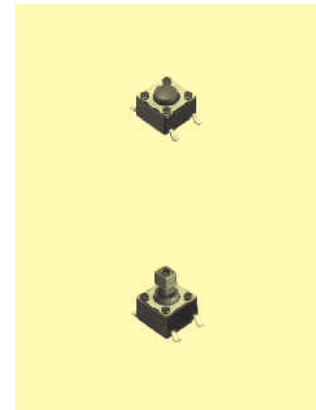

Ordering code:

Switches

TSS 6

Colour of stem
for operating force:

Dimension H/Packing:

- | | | | |
|-----------------------------|-------------------------------------|----------------------------|---------------|
| <input type="checkbox"/> 1 | 4.3 mm / 1000 pcs/reel | <input type="checkbox"/> K | 1.0 N, black |
| <input type="checkbox"/> 2 | 5.0 mm / 900 pcs/reel | <input type="checkbox"/> N | 1.6 N, brown |
| <input type="checkbox"/> 3 | 7.0 mm / 700 pcs/reel | <input type="checkbox"/> R | 2.6 N, red |
| <input type="checkbox"/> 44 | 7.3 mm / 700 pcs/reel* | <input type="checkbox"/> S | 3.2 N, salmon |
| <input type="checkbox"/> 5 | 9.5 mm / 380 pcs/reel | <input type="checkbox"/> Y | 5.2 N, yellow |
| <input type="checkbox"/> 6 | 13.0 mm / 77 pcs/tube | | |
| <input type="checkbox"/> 7 | 11.0 mm / 77 pcs/tube, 300 pcs/reel | | |

* only with square stem

Caps KTSC-6

Cap type:

- | | |
|----------------------------|--------|
| <input type="checkbox"/> 1 | square |
| <input type="checkbox"/> 2 | round |

Cap colour:

- | | |
|----------------------------|--------|
| <input type="checkbox"/> B | blue |
| <input type="checkbox"/> G | green |
| <input type="checkbox"/> I | ivory |
| <input type="checkbox"/> K | black |
| <input type="checkbox"/> R | red |
| <input type="checkbox"/> Y | yellow |